

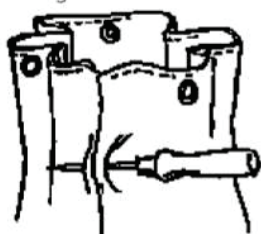

## LEVERLOCK SYSTEM PR-02

Bag with internal seam



Bag with external seam

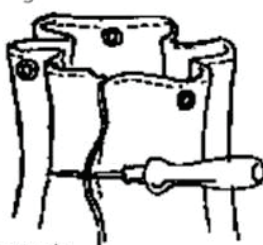

Hole 15 cm from mouth

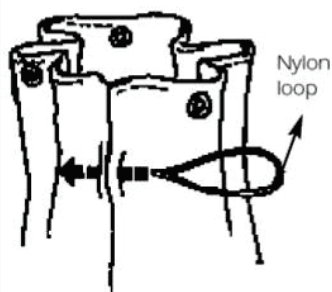

Nylon loop

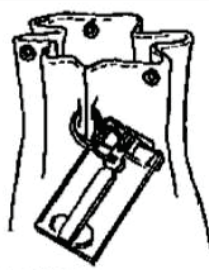
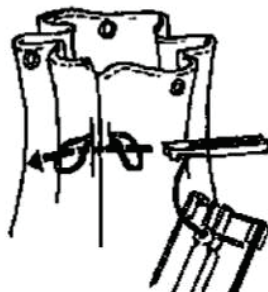

### Attention

Leave the Leverlock on the bag, even when you are not using it. Leverlock has to be permanently in position. This permanent fixture assures that each bag has its own Leverlock, adjusted and ready for immediate use.

Keep the Leverlock closed. Closed, the Leverlock forms a solid and resistant block. When leaving the cover open, there is always the risk of breakage.

Insert the end of the nylon thread into the position on the lever that provides the desired adjustment.

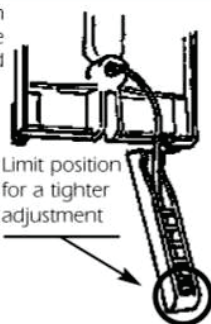

Limit position for a tighter adjustment

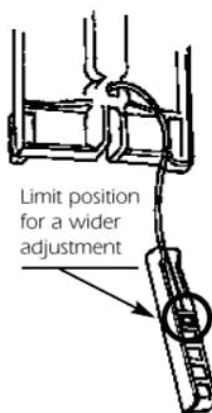

Limit position for a wider adjustment

Adjustment may also be obtained by inserting the other end of the thread in one of the 7 adjustment holes located at the Leverlock base.

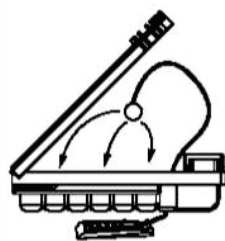

Too loose.

Shorten size of cord.



Too tight.

Lengthen size of cord.



Bad handling.

Avoid breaking hinge joint. Always hold the base, never the cover.

TO FIX

ADJUST

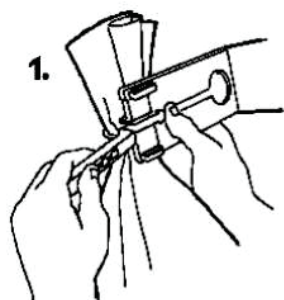

1. Wrap the nylon thread around the bag and insert the lever into the guide slot of the Leverlock base.

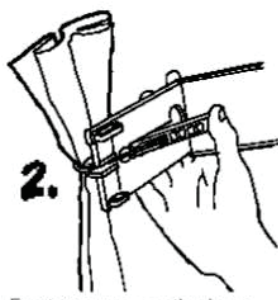

2. Exert pressure on the lever until it comes together at the bottom of the Leverlock base.

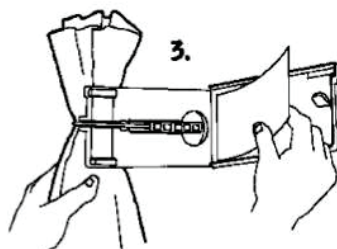

3. Place the label inside, and close the Leverlock.

Verify the seal has no defects.



Perfect seal.

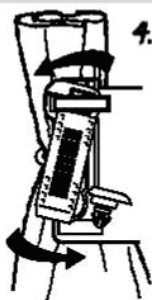

4. Insert the "hook" end of the seal into the open slot of the Leverlock base and move it sideways.

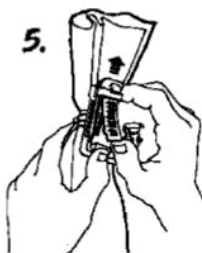

5. Pull the seal until its other end is free.

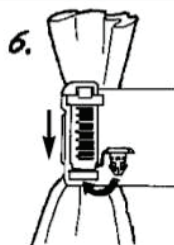

6. A) Pull the seal as shown in the picture to bring it to its final position.

B) Insert the anchor into the closing capsule.

A broken connection may amount to a violation. If the connection thread breaks, use a different seal.



Exert a small amount of pressure on the sharp end of the capsule to make sure if the seal is securely closed.



Make sure that the "hook" of the seal was inserted correctly



**Important:** if the closing operation is made with no regard to the directions above, the agent is responsible for occurrences.

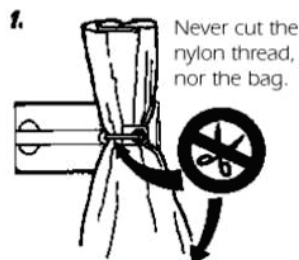

1. Never cut the nylon thread, nor the bag.

To open, hold the central part of the seal and tear it away.

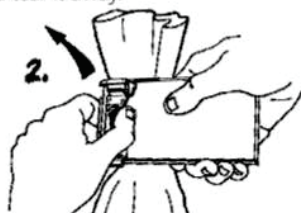

Base of the seal.



The seal, after opening.

Keep the Leverlock, the seal and its base until final verification. Loss of any of these pieces, when irregularities occur, makes the employee responsible. Any irregularity, call your security personnel. If a further inspection should take place, ALL mentioned pieces (Leverlock, seal and base) must be presented. When all is determined to be in order, then destroy the seal.